

KEY

EXISTING DOWNPIPE

PROPOSED DOWNPIPE

EXISTING STORMWATER

PROPOSED STORMWATER

RAINWATER TANK
(1,800 Litres)

STORMWATER TO BE CONNECTED TO
RAINWATER TANK AS SHOWN.
OVERFLOW TO EXISTING SYSTEM
AS PER AS 3500

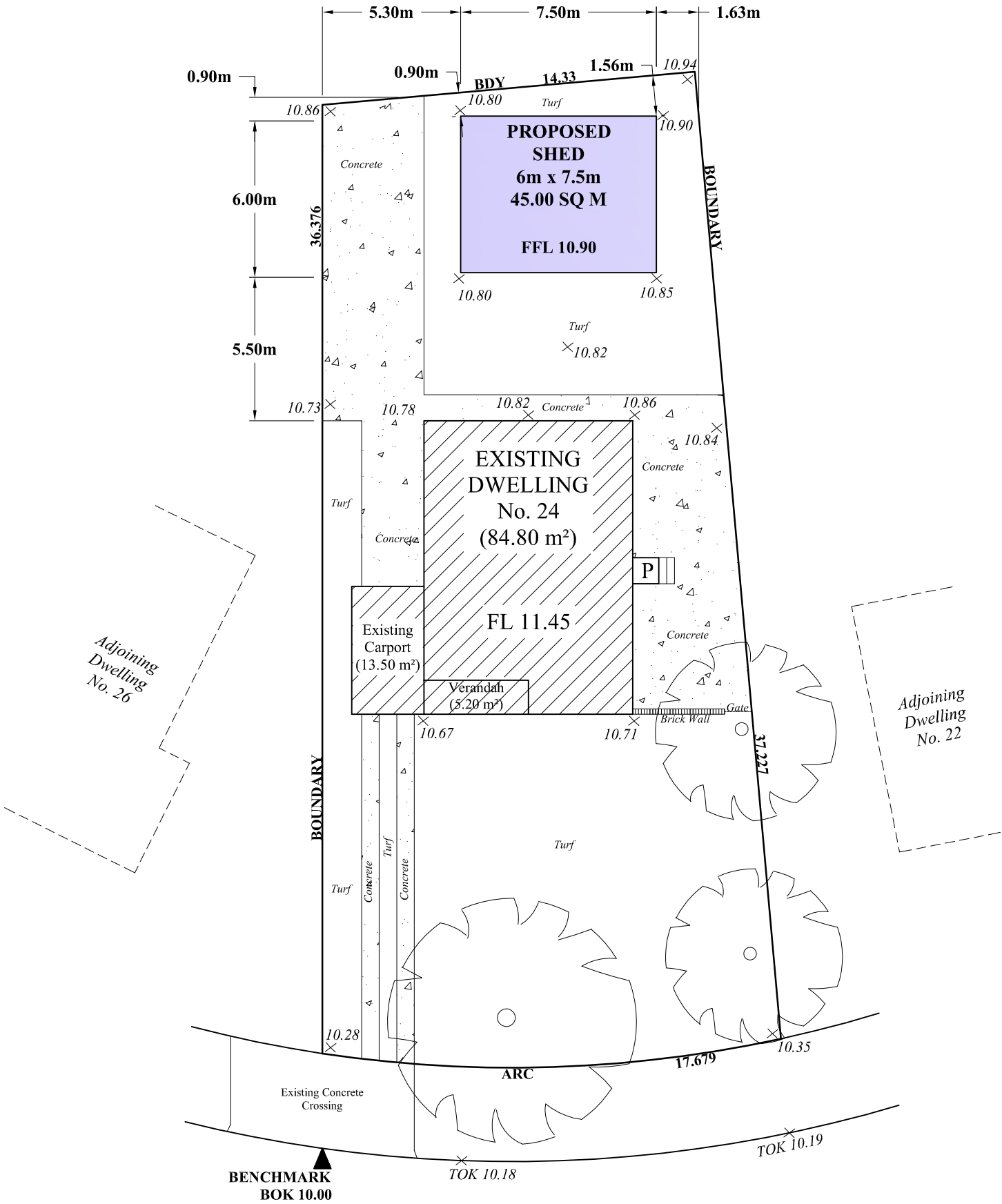

KOOMOOLOO CRESCENT

SITE AREA	592.00 SQ M
EXISTING FLOOR SPACE	103.50 SQ M 17.48 %
PROPOSED FLOOR SPACE	155.50 SQ M 26.26 %
EXISTING SITE COVERAGE	84.80 SQ M 14.32 %
PROPOSED SITE COVERAGE	136.80 SQ M 23.10 %
PROP. LANDSCAPED AREA	303.10 SQ M 51.19 %

LOT 91
D.P. 255726

SITE PLAN	DRAWN BY: Serge Panayi 12 Valmay Avenue Picnic Point NSW 2213 Ph: (02) 9785 2940
SCALE 1:200 @ A3	Date: 28/11/12 Council: BLACKTOWN
PROPOSED SHED AT: 24 KOOMOOLOO CRESCENT SHALVEY NSW 2770	PLAN NUMBER: 02 REVISION NUMBER: 00